



Sky Hotel

CTU Prague - Faculty of architecture 6th term 2012/2013

Jaromír Krejčí

ATBP, studio Stempel & Beneš

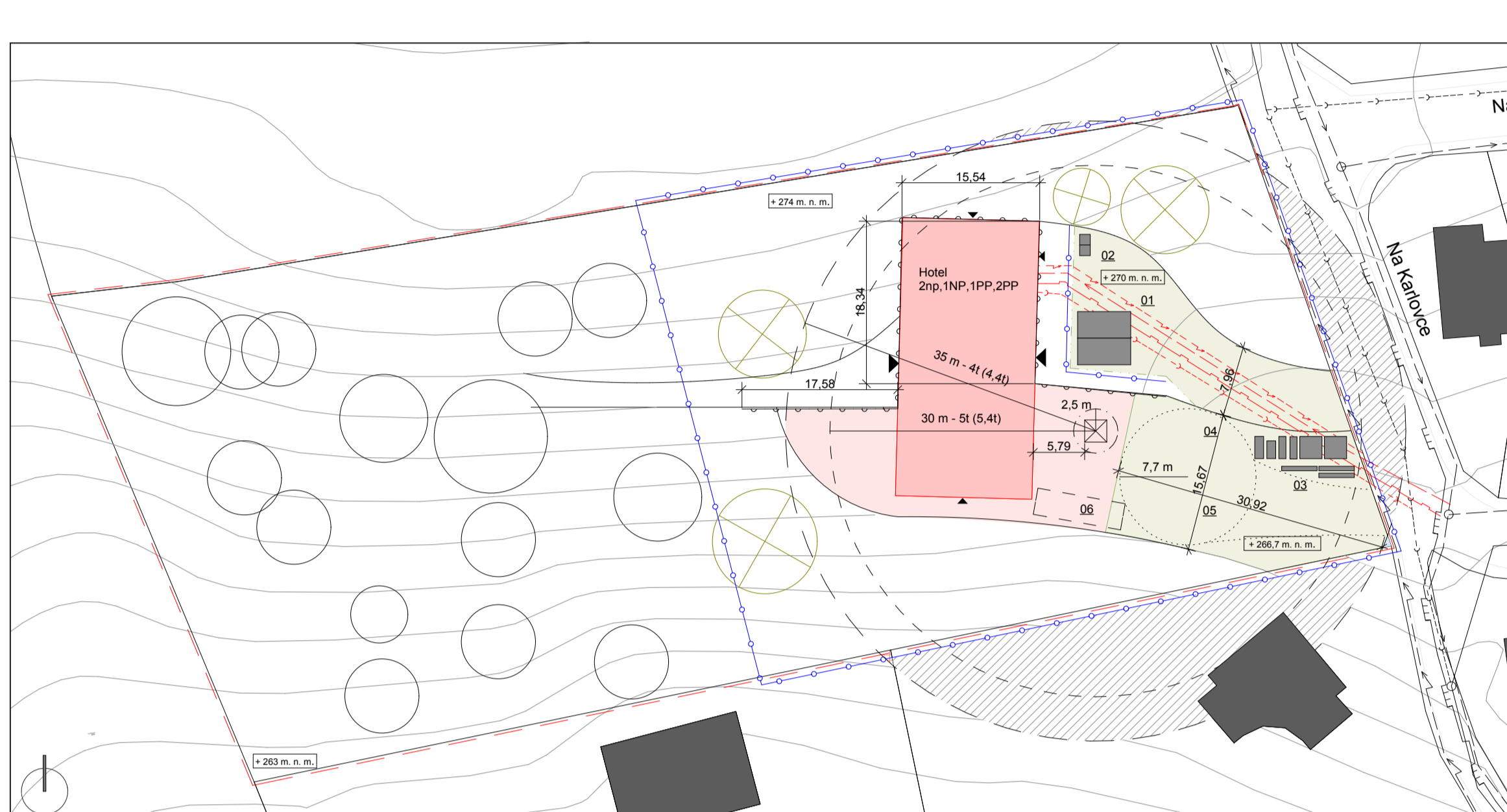

The hotel is situated in a lucrative area of Prague called Hanspauka. The site has about 7150 m² and its cant from the lowest point to the highest is 12 m. Thanks to these properties a visitor has a very beautiful view to the Prague Castle.

The hotel reflects the sloping site. This feeling should be induced by the monument staircase. The visitor can also do this solution look through the all floors. From the groundfloor you can see the "SKY" behind the skylights.

On the second floor there are twelve double-bed rooms and one cleaning room. The first floor is similar like a second except for the barrier - free room next to the elevator.

The hotel restaurant and an entrance hall is situated on the ground floor same as an office and a restaurant kitchen.

On the underground floor there is a bowling, a conference room, WC and a technical room.

Every floor (except the second) is accessible from the terrace. It is also good for a safety of people during an evacuation.

Materials of the object are very well readable at first sight. Plaster is used for the upper part with guest rooms. There are clear and simple lines. Due to the high percentage of glazing on the ground and underground floor, there are used sunblinds.

